

# FR43

WR-4.3 waveguide isolator



# MicroHarmonics

Superior mm-Wave Components

25-400 GHz

## Specifications

Flange	WR-4.3
Frequency (GHz)	170-260
Insertion Loss (dB, typ)	1.7
Insertion Loss (dB, max)	3.2
Isolation (dB, typ)	22
Isolation (dB, min)	18*
Input Return Loss (dB, typ)	20
Output Return Loss (dB, typ)	20
VSWR (max)	1.5:1
Maximum Power (W)	0.7
Diamond Heatsink	Yes

\*Isolation 16 dB min below 175 GHz.

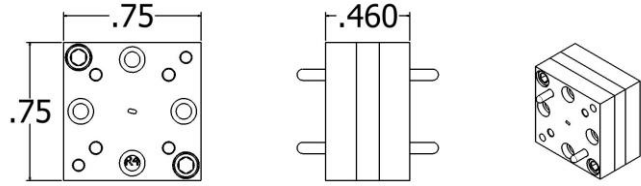

- ◆ Anti-cocking waveguide flanges
- ◆ Comprehensive test data
- ◆ Lowest insertion loss
- ◆ High isolation
- ◆ Compact size
- ◆ Diamond heatsinks
- ◆ Resist stray magnetic fields



Every isolator is tested on a vector network analyzer to ensure conformity and the test data is provided.

