

FR90

WR-9 waveguide isolator



MicroHarmonics

Superior mm-Wave Components

25-400 GHz

Specifications

Flange	WR-9*
Frequency (GHz)	82-122
Insertion Loss (dB, typ)	1.0
Insertion Loss (dB, max)	1.8
Isolation (dB, typ)	24
Isolation (dB, min)	18
Input Return Loss (dB, typ)	20
Output Return Loss (dB, typ)	20
VSWR (max)	1.4:1
Maximum Power (W)	2.1
Diamond Heatsink	Yes

Test data measured and synthesized using WR-10 and WR-8 extenders.

*WR-9 is a non-standard band (90 x 45 mils).

Every isolator is tested on a vector network analyzer to ensure conformity and the test data is provided.

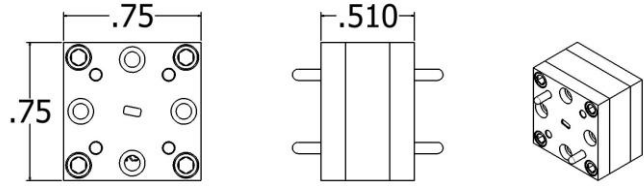

- ◆ Anti-cocking waveguide flanges
- ◆ Comprehensive test data
- ◆ Lowest insertion loss
- ◆ High isolation
- ◆ Compact size
- ◆ Diamond heatsinks
- ◆ Resist stray magnetic fields

