

# FR34M2

WR-3.4 waveguide isolator



# MicroHarmonics

Superior mm-Wave Components

25-400 GHz

## Specifications

Flange	WR-3.4
Frequency (GHz)	220-330
Insertion Loss (dB, typ)	2.3
Insertion Loss (dB, max)	3.5
Isolation (dB, typ)	22
Isolation (dB, min)	18
Input Return Loss (dB, typ)	19
Output Return Loss (dB, typ)	19
VSWR (max)	1.6:1
Maximum Power (W)	0.4
Diamond Heatsink	Yes

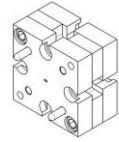
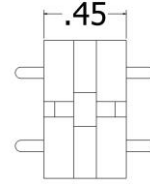
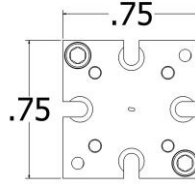

- ◆ Anti-cocking waveguide flanges
- ◆ Comprehensive test data
- ◆ Lowest insertion loss
- ◆ High isolation
- ◆ Compact size
- ◆ Diamond heatsinks
- ◆ Resist stray magnetic fields
- ◆ Internal waveguide screw access



Every isolator is tested on a vector network analyzer to ensure conformity and the test data is provided.

